

HYDE LANE

UNIT TYPE	G
FLOOR AREA	28m ²
LEVELS	02-10

Unit 07

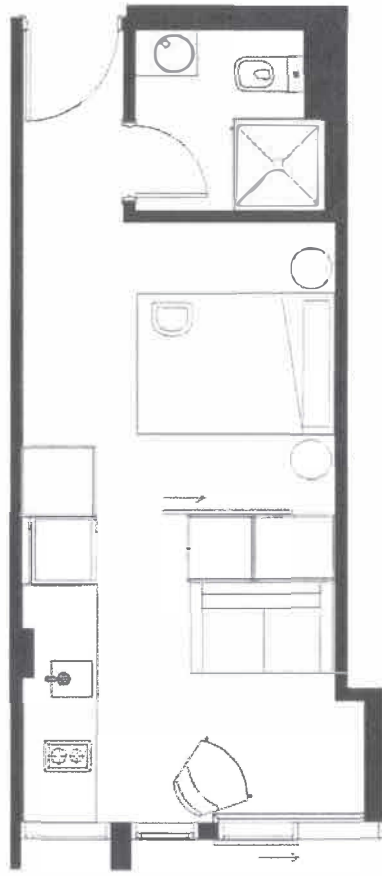

Type G



UNIT LOCATION

NOTE: Windows, Juliette balconies and exterior fin location may change on each level, Please refer to elevations or specific level plan. Brace shown by hatched lines if below 180cm.

Hyde Lane is a new residential development located in the heart of the city. The development consists of a 10-story building with a total floor area of 280,000 sqm. The building is designed to provide a high-quality living environment with modern amenities and a secure environment. The development is situated in a prime location, close to the city center, and offers easy access to public transport and shopping facilities. The building is designed to provide a high-quality living environment with modern amenities and a secure environment. The development is situated in a prime location, close to the city center, and offers easy access to public transport and shopping facilities.